



Chicago ASPENews



Chicago Chapter of the American Society of Plumbing Engineers
Vol. 40, No. 5
December, 2008



BOOSTER NIGHT Thursday December 18, 2008

LaVilla Restaurant and Banquets
3636 North Pulaski; Chicago, IL
(Plenty of Free Parking)

AGENDA

5:30pm-9pm Cocktail Hour, **OPEN Bar** - Beer, wine and cocktails (well drinks only) compliments of ASPE Chicago's Affiliate Boosters!!

6pm-9pm **(all night!)** Special Entertainment - **Vito Zatto, Las Vegas Style Revue**

6:30pm Dinner - \$25 Members / \$25 Non-Members

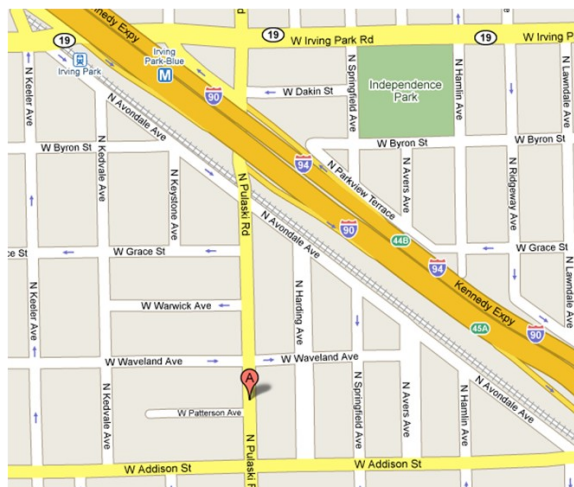

MENU

Appetizers

- Pyramid of Shrimp
- Brushetta
- Baby meat balls

Dinner

- Cream of Roasted Red peppers soup
- Salad (choice of dressing)
- Bow tie pasta with Pomodoro Sauce

- Châteaubriand (a small roast extravagantly cut from the center of the beef tenderloin)
- Chicken Marsala
- Peas/ Mushrooms/ Onions
- Double Baked Potatoes

Dessert

- Cake Roll with Chocolate Sauce

RSVP as soon as possible to Bruce Weiss, VP Technical!

- Return the enclosed card for those of you getting this via US Mail
- Call 312.212.2022
- Fax 312.212.6401
- Email Chicago.ASPE.RSVP@gmail.com



Local Chapters are not authorized to speak for the Society



PRESIDENT'S MESSAGE

HAPPY HOLIDAYS! DON'T MISS BOOSTER NIGHT!!!

Please see the cover of this newsletter for more information. Bruce's article has some additional info, too. [Vito Zatto](#) will be there to entertain us! He is a top-notch entertainer and will be the best we have ever had! No technical presentations, no primer, no CEU's, butfree beverages, lots of food, and plenty of laughs! It's also a great opportunity for networking. We will probably have over 100 people at this "meeting"! Make sure that you are one of them! You will NOT be disappointed! And it's only \$25 for members AND non-members!! **Look for the sponsor lists at this event and please thank our sponsors! This is another event that wouldn't happen without them!**

THANK YOU, BOOSTER NIGHT SPONSORS!!!!

I know that I said this last month, but in case you missed it: Please check out the line cards of our supporters! When is the last time you looked at our line card web page? <http://aspe.org/Chicago/linecards.htm>. You can also use the ASPE Chicago Directories that we distribute as PDF's.

November meeting was great!

I think that our November meeting in Rosemont was maybe the best meeting so far this year! Then again, I like all of them! We had a great dinner at a new (for us) venue and the Technical Session was top-notch! It's amazing that we can still get interesting information on topics like booster pumps that we have reviewed so many times. Vince and Harry did a great job of covering some things that we might have known and some things that maybe we didn't. We had 76 happy attendees and it seemed to be unanimous that this was a great meeting. We are planning to return there in January. Mark your calendars!

ASPE Chicago elections are coming up in May

Now is the time to start thinking about running for a board position. We will have at least a couple of people leaving the Board; so, this could be your chance! Why not sit in on a Board meeting sometime to see what we do. The meetings are always open to members in good standing. Please email me at ddebord@esdesign.com for more information.

David DeBord, CPD LEED AP; President
ddebord@esdesign.com; 312 456.2359



FELLOW AFFILIATES

By now you have received an email requesting you to participate as a sponsor for the ASPE Chicago **BOOSTER NIGHT**. By helping to support this event, you will not only insure its success but will also be recognized as a supporter. Remember, ASPE Chicago supports those who support the Chapter!!

Thanks to those who have already sent checks. If you haven't received this information, please call or email me and I will send to you.

Thank you!!

Richard Simms, Affiliate Liaison
dsimms@deery-pardue.com; 847 910.8873

CHAPTER OFFICERS

PRESIDENT

David DeBord, LEED, CPD
Environmental Systems Design
312 456.2359
ddebord@esdesign.com

VICE PRESIDENT TECHNICAL

Bruce Weiss, CPD
Affiliated Engineers
312 212.2022
bweiss@aeieng.com

VICE PRESIDENT LEGISLATIVE

Frank Sanchez, CPD
Grumman/Butkus Associates
847 328.3555 x251
fxs@grummanbutkus.com

VICE PRESIDENT MEMBERSHIP

Rick Butler
Luczak Sales
847 781.5100
rick@luczak.com

TREASURER

Mark Mannarelli
Environmental Systems Design
312 456.2354
mmannarelli@esdesign.com

ADMINISTRATIVE SECRETARY

Natalia Dankanich
Grumman/Butkus Associates
847 328.3555 x208
nkd@grummanbutkus.com

CORRESPONDING SECRETARY

Jerry Fields
Luczak Sales
847 781.5100
jerry@luczak.com

AFFILIATE LIAISON

Dick Simms
Deery-Pardue & Associates
630 350.7575
dsimms@deery-pardue.com

EDUCATION CHAIRMAN

Dan Fagan, PE, CPD
OWP/P
312 960.8301
dfagan@owpp.com

NEWSLETTER EDITOR

Jason McDonald, CPD
Grumman/Butkus Associates
847 328.3555 x204
jsm@grummanbutkus.com

WEBMASTER

Jim Moynihan
Chicago Technical Sales
630 889.7121
CTSalesInc@aol.com

GOLF OUTING CHAIRMAN

Steve Triphahn
W-T Engineering, Inc.
847 895.3640
steve.triphahn@wtengineering.com

HISTORIAN

Donald Johnson

WEBSITE

<http://www.aspe.org/Chicago>
("C" is required)



NOVEMBER MEETING RECAP

Location, Location Location a meeting location more accessible to the suburban members. We tried a new venue for our November meeting and from the feedback my fellow Board members and I received, I think we found a new meeting location. The Rosewood staff treated us very well (I like the towels before dinner) and the food was outstanding. If that wasn't good chicken breast I don't know what is. We will be back at the Rosewood in January 15; so, mark your calendars.

The Primer - Medical Gas Inlets/Outlets

Scott Brykalski, District Sales Manager of Ohio Medical Products brought a variety of inlets and outlets and the new Integrated Flowmeter. He did a very nice show and tell of what is available for medical gas outlets in the current market. Thanks Scott for taking the time on your hockey night to give the primer.

The Technical Program - Variable Speed Drives and their Implications on Booster Pumps

Victor Rilling, President of Advanced Mechanical Technologies gave an excellent presentation on booster pumps. The initial presentation was directed on the effect or variable drives and booster packages. Victor not only covered that, but also many other considerations on pumping such as hydro-pneumatic tanks, impellers and motors. Overall it was a very good presentation. I also want to say that with all the pumps guys who attended, Victor held his own very well. Special thanks to Ed Lichner and Luczak Sales for providing a speaker for this meeting.

WHAT'S PLANNED FOR BOOSTER NIGHT?

This is what's planned - The Vito Zatto Las Vegas Style Revue!

Last year we had an open bar and a Belly Dancer - how do you beat that? You have an open bar and **Vito Zatto** - that's how. I don't think I need to spend much time describing what an open bar is, but I may have to explain Vito. The best way to describe Vito is just to send you to his website, www.vitozatto.com and you can take a look for yourself. Yes it is true that the Chicago Chapter is providing you with entertainment the caliber of WGN news. How can we do that for you in these tough economic times you ask? You can ask is all we'll say to that. Come and see Vito for Yourself on December 18 at LaVilla.



Booster Night is the time for the Chapter to give back to its members and also throw a good party. Why do we do this? To encourage each of our members to bring a fellow worker, maybe an ASHRAE member, to come see what we are all about. So tell a coworker, a friend or anyone else to come along. If an existing member brings a new member (AND the new member brings a completed application and payment), both will get dinner for free!!! Dinner will be \$25 for everyone else.

Bruce Weiss, CPD; Vice President Technical

bweiss@aeieng.com; 312 212.2022



GREETINGS FROM YOUR ADMIN SECRETARY!

I'll be very brief this time. I would like to introduce winners of the night at our November meeting. Jim Feeney of Primera won a free dinner and Mike Imaoka of MGN was the 50/50 raffle winner. Mike donated his winning to Toys for Tots. It is very generous of him. Congratulations guys!

I hope all of you had a great Thanksgiving. See you all in December at Booster Night. Don't forget to bring a good holiday spirit with you.

Natalia Dankanich, Administrative Secretary

nkd@grummanbutkus.com; 847 328.3555 x208



LEGISLATIVE CORNER

The Great City of Chicago Plumbing Code “Informal” Interpretations

Every Code has tons of gray areas that we require formal clarifications. Without any doubt, having a good understanding of local codes will avoid problems on your projects. These conflicts can affect budgets and even delay construction schedules.



Consequently, I am going to start a series of “*informal*” interpretations of the City of Chicago Plumbing Code. I would like to receive your questions regarding specific sections that you recently faced on a project and would like to share or sections that you consider ambiguous. I will contact the local jurisdictions and will try to obtain an answer.

At the same time, I will provide basic explanations of the systems discussed. These “informal” interpretations can also be used to educate our fellow contractors, architects and one or maybe two inspectors (*from out of town of course!!*)

I am referring to them as “informal” until I create a final list that will be signed and stamped by the City. Therefore, please remember that you should check your local codes and contact the authorities having jurisdiction because they have the final word on code interpretations.

As always, I am looking forward to receiving feedback from our members. I will select some of your comments and will use them to expand our “informal Interpretations” of the code.

Part I - What are the backflow requirements for Mop Basins in the Great City of Chicago?

A vacuum breaker is defined (18-29-202) as a type of backflow preventer installed on openings subject to normal atmospheric pressure that prevents backflow by admitting atmospheric pressure through ports to the discharge sides of the device.

The City of Chicago Code (section 18-29-608 Protection of Potable Water Supply) refers to atmospheric vacuum breakers (AVB) as *Backflow Preventer with Intermediate Atmospheric Vents* and they are meant for *Low Hazard* use on *Backpressure or Backsiphonage (sizes 1/4” to 3/4”)* applications.

The applicable standards are ASSE 1012 (Performance Requirements for Backflow Preventer with Intermediate Atmospheric Vent) and CSA CAN/CS-B64.3 (Backflow Preventers and Vacuum Breakers).

An Atmospheric Vacuum Breaker (AVB) is a backflow prevention device used in plumbing to prevent backflow of non-potable liquids into the drinking water system. It is usually constructed of brass and resembles a 90-degree elbow with a hood on its top to allow air to enter the water system if a siphon attempts to form. Inside this elbow is a poppet valve that is held up by the water pressure found in the system, closing the air entrance to the device. If the pressure in the “*upstream side*” is reduced to atmospheric pressure or below, the poppet valve drops and allows air to enter the system, breaking the siphon.

For years, I provided elevated vacuum breakers at 7’-6” above the finish floor; it was a commonly adopted method. However, this is no longer the case. The Great City of Chicago is accepting AVBs installed at the faucet spout.

However, there are several important items to keep in mind:

These devices, since they work on atmospheric principles, cannot be installed in an enclosure containing air contaminants. As air is a fluid, those contaminants could be drawn into the device, thus fouling the pipes. The AVB should be installed at least six inches above the highest use downstream.

(continued on page 5)

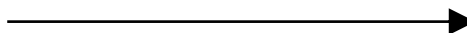

LEGISLATIVE CORNER (cont'd)

As indicated previously, AVB's are for "Low Hazard" applications only and should not be used with continuous pressure on the device as the poppet would likely stick and the AVB would no longer function properly. A shutoff valve should never be placed downstream of **any** AVB as this would result in continuous pressure on the AVB. Also, remember that the AVB is not a testable device.

Finally, please keep in mind that Article XII has a particular requirement regarding swimming pools. Refer to section **13-96-750, Inlets**

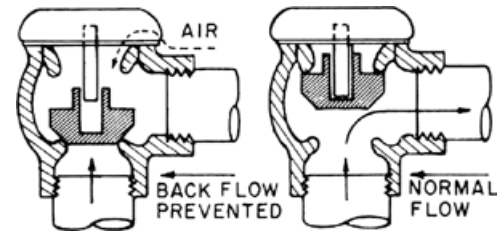

**Atmospheric Vacuum Breaker
Operation**

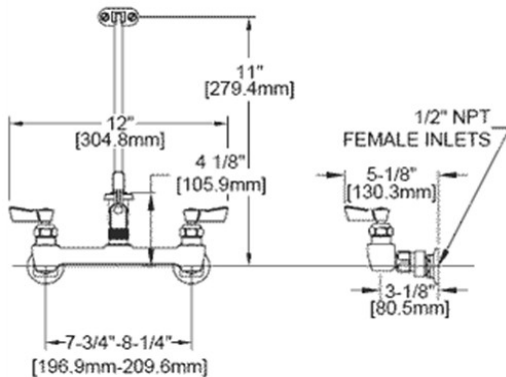

(b) [...] If a hose connection from a sill cock or other plumbing fixture is to be used for supplying make-up water, then an approved vacuum breaker shall be installed between the sill cock or control valve at the fixture and the hose connection. The vacuum breaker shall be installed at a height not less than **seven feet six inches above the floor, platform or ground** upon which a person would stand when operating the sill cock or control valve.

Therefore, if your mop basin will be installed near a pool where it may be used to supply make-up water, then please provide an elevated vacuum breaker at the specified height.

P.S.: Beware of soap dispensers that magically appear on the wall of Janitor Closets. If they are there, then the AVB on the spout does not meet code!

On my previous VP-Leg article I provided a list with the names of local inspectors,

City of Chicago Plumbing Bureau can be reached at 312 743.7477

http://egov.cityofchicago.org/webportal/COCWebPortal/COC_EDITORIAL/TechnicalInspectionsPeterOusley.pdf

Please contact me with your questions and comments. Thank you.

Frank Sanchez, Vice President Legislative
fxs@grummanbutkus.com; 847 328.3555 x251

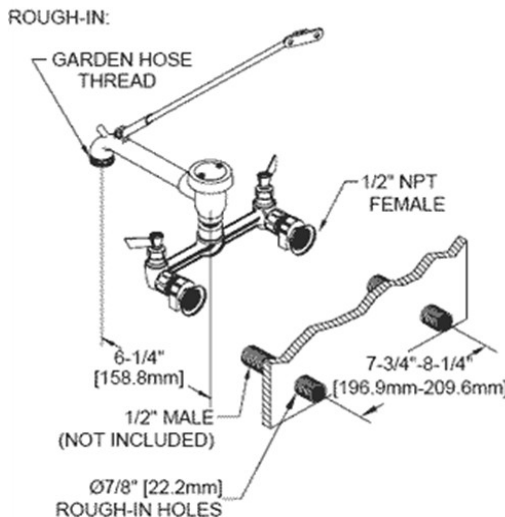

**Mop Basin Faucet with Atmospheric
Vacuum Breaker**

Legislative Tips:

Did you know that the latest and City of Chicago Code is available online?

<http://www.chicagocodes.com/>



HOW DO YOU LIKE YOUR CURVES?

There is an interesting article in the November *Plumbing Engineer* as well as the November *PS&D* magazines regarding one of the most important tools in our design tool bags. Mr. Dan Cole of Lake Zurich, IL has written an extensive history on the origin and development of the fixture unit values and Hunter's Curve by Dr. Roy B. Hunter. Dr. Hunter began this work in the 1920's and the fixture unit values and Hunter's Curve have been in our design work since then.

Don Johnson, Chapter Historian



YEAR IN REVIEW

Man did this year fly by!!!! Here it is a recap on Membership for 2008:

Last year at this time we had 360 members. We now have 387, although we did hit **400** in June. The good news is that we grew by 27 members or about 7%. The bad news is that we *LOST 13 members!?*

Other Membership Interesting Facts:

We have; 152 Full Members, 60 Associates, 130 Affiliates, 1 Government (CIA), 31 Special (Contractors or end users), 4 Students, 10 Retired (I wish), and 64 of our members have CPD's.

It seems we lose many members after their first year; so, here is a list of the 2008 new members. One reason is to recognize them for joining our Chapter; the other is to let you know that we know who you are and you cannot leave.....pleeaaasseeeee.

Kelli Aiardo	Scott Jagodzinski	John Panek
George Alcala	Barry Janovsky	Daniel Patt
Theresa Allen	Patrick Kennedy	John Peterson
Blake Anderson	Richard Klaess	Ronald Pison
Shafi Ansari	Robert Kogut	John Pritchard
John Baethke III	Neil Kowalski	Donald Rasich
Jamal Belahmira	Apple Wingyin Lau	Jeanne Reid
Michael Belczak	Charles Lee	Jason Romano
Karampal Bhatti	Edward Lichner	Anthony Saracino
Shawn Block	Patrick Lynch	Christopher Sbarbaro
Charles Cohon	John Lynch	Robert Smith
Daniel Fishbone	Edward Mathisen	Brandon Taylor
Jon Franzese	Steven McGuire	Ross Watson
Lisa Garcia	Edward Mjolsnes	Christopher Wisinski
Joseph Hainaut	Michael Monthey	Ralph Wisniewski
Andrew Higgins	Donald Netzel	*Greg Nagrant
Larry Himmelblau	Ryan Ohm	<i>*Newest of the new</i>
Daniel Hitner	David Ostrum	

Again, thank you all for making the commitment to ASPE Chicago. **Now we cannot wait to see you all at the December BOOSTER night.** I have seen the entertainment in the past and it is first class! Great singing, and jokes for all! Happy Holidays to all!!

Rick Butler; Vice President Membership

rick@luczak.com; 847 781.5100



CORRESPONDING STUFF

ASHRAE, www.illinoisashrae.com

USGBC LEED Leaders & Liters

Tuesday, December 9, 2008

Pompeii; 17W744 22nd Street; Oakbrook Terrace, IL

6pm - 8pm: LEED Leaders & Liters is an event held several times a year to help increase the USGBC - Chicago Chapter membership. It is a forum for attendees to network with each other and discuss use of the LEED rating system. This event is hosted by the West Suburban Branch of the Chicago Chapter and will discuss geothermal energy systems

SFPE, www.chicagosfpe.org

Western Society of Engineers - Proposed New Nuclear Plant Projects Impact on the US Economy

Tuesday, December 2, 2008

6pm - 8:15pm (Dinner Served at 6:30pm)

Costa's; 340 S. Halsted, Chicago, IL

Member \$35, Non-Member \$45; Complimentary valet parking, too!

Speaker: Dennis Demoss, senior Vice President and Project Director Sargent & Lundy

ILPHCC, www.ilphcc.com

PAMCANI - Keeping Your Head above Water Seminar

Saturday, December 13, 2008

Holiday Inn Rolling Meadows; 3405 Algonquin Road, Rolling Meadows, IL; 847 506.4121

9am - 3pm

Jerry Fields; Corresponding Secretary

jerry@luczak.com; 847 781.5100



HELLO FELLOW MEMBERS

Just a little tad-bit on some plumbing history:

There is no question that our health has improved spectacularly in the past century. One thing seems certain, it did NOT happen because of medicine, or medical science or even the presence of doctors.

Much of the credit should go to the plumbers and engineers of the Western world. The contamination of drinking water by human feces was at one time the single greatest cause of human disease and death for us; it remains so, along with starvation and malaria, for the Third World countries. Typhoid fever, cholera and dysentery were the chief threats to survival in the early years of the 19th century, mainly in New York City and highly crowded and populated areas, and when the plumbers and sanitary engineers had done their work in the construction of our cities, these diseases began to vanish.

Just remember this when asked if plumbers make more money than lawyers:

A lawyer in California needed a leak fixed and called the plumber; who after about 45 minutes was done and all cleaned up. "That will be \$75", said the plumber. The lawyer objected saying "I'm a lawyer, and I don't even get that much an hour!" The plumber responded, "I didn't either, when I was a lawyer".

Hope to see all of you in December for Booster Night. If you can't make it to the December meeting have a wonderful and Joyous Holiday with family and friends.

You're beloved Treasurer,

Mark Mannarelli, Treasurer

mmannarelli@esdesign.com; 312 456.2354



38th ANNUAL ASPE CHICAGO CHAPTER PRODUCT SHOW

KICK-OFF MEETING - SAVE THE DATE

Monday December 15, 2008; 6:30pm

Hopleaf (Andersonville); 5148 N Clark St, Chicago, IL; 773 334.9851

[Click here for directions](#)

Last year we had a successful show. Not only was the attendance great, but we also provided excellent prizes and high quality seminars.

Year after year we make changes and tweaks to the show; our main goal is to provide our exhibitors with an appropriate space and time to display their products and provide our members with outstanding network opportunities and diversified education. Also, in order to make our past show more appealing we provided spectacular prizes: a flat screen TV, digital cameras, GPS units and dozens of prizes given by our exhibitors. These are some of the reasons you could call our yearly show the ASPE Chicago Plumbing Convention.

Kudos to **Mr. Phill Kroll**, from Metro Design, for accepting the position of Product Show Co-chair. I am extremely confident that together we will make the appropriate changes to promote and improve our show.

I have a few revolutionary ideas for the show. However, I can't achieve them alone; I need your insight and support. So, please come to the Product Show committee meetings - I will listen to ALL your comments and suggestions. You can be assured I will work hard to make the 2009 Product Show a success - better and bigger than before.

Manufacturers and manufacturer representatives, you are the keystone of the Show and I need feedback from you. There is a plethora of ideas floating up in the air and I believe we can materialize a few of those ideas in the near future. For instance:

- ⇒ *Would you be interested in early bird registration discounts?*
- ⇒ *What do you think about dinner? Should we cancel it, provide food at the floor and end the Show earlier?*
- ⇒ *Do you know of other locations that can accommodate our show?*
- ⇒ *What do you think about hosting the Product Show every two years instead of every year?*
- ⇒ *How many shows do you attend per year and how much do you pay per booth at other events?*
- ⇒ *How do they compare to the Chicago Chapter PS and technical seminars?*
- ⇒ *What about the seminars time frame? Should we start later and finish later to keep the seminar attendees at the show?*

If you want to make your voice heard, PLEASE come to the kick-off meeting or send me an email.

Also, I am in looking for [volunteers](#) willing to assist with the Product Show,

*I am in search of a web savvy person to study the possibility of online registration and create online surveys.
Call our past exhibitors to update their contact information and confirm Show attendance.
Map our membership workplace location and use this to propose alternative Product Show locations.
Study new ways to promote our Show.*

Note that during all our meetings our generous Chapter will provide snacks and beverages. You can attend to simply listen and provide feedback, but I would like you to volunteer. Together we will make this the best ASPE Chicago Product Show ever!

Regards,

Frank Sanchez, CPD; ASPE Chicago Chapter Product Show Chairman
fxs@grummanbutkus.com; 847 328.3555 x251



TOYS FOR TOTS

2008 will be ASPE Chicago's fourth year contributing to **Toys for Tots**. We will have toy collection boxes at Booster Night (December 18) and we would like you to all bring at least one new, unwrapped toy to benefit a needy child this holiday season.

If you do not know, the **Toys for Tots** program started in 1947 and continues today as a program of the United States Marine Corps Reserve. Their goal is "delivering a message of hope and bringing the joy of Christmas to America's less fortunate children." You can find more information about this program at www.toysfortots.org.

Yes, this is a Christmas thing; but, we hope that you will help out the children regardless of creed. This is a tough year and we expect a lot more children in need this holiday season. Let's try to make it a little brighter for them!

Please consider supporting this program and bring at least one new toy to Booster Night. The toy(s) can be for boys or girls, ages birth-12 years and can be pretty much anything a kid might like – game, stuffed animal, DVD, gift card.... whatever your heart (or your own kids) tells you. Here is a quick explanation of what happens:



- We donate new, unwrapped toys at Booster Night
 - We deliver the toys to the US Marines on Foster Avenue where the toys will be sorted by age and gender – this is why we do not gift wrap them
 - Community groups, schools, churches, shelters, etc. who can identify the children in need will make requests to the Marines for whatever toys they need (e.g., they may need toys for 2-12 year old girls, 3-6 year old boys, etc.) – these are the people who will then do the gift wrapping
- Needy children receive the toys and give lots of smiles in return

Toys for Tots gives out approximately 2.2 toys per child. No, they do not give partials – this is an AVERAGE!! So if we collect 220 toys, that would mean that we are helping about 100 children! Pretty cool feeling, huh??

In addition to the toy drive, our Booster Night 50/50 raffle will benefit **Toys for Tots**. So, we will have a nice cash donation to give them. Toys for Tots was also the benefactor of the November 50/50 raffle that raised \$200. The winner of the 50/50, Mike Imaoka, generously donated his winnings which means we already have raised about \$400 for **Toys for Tots**. Right on!! Thanks to Mike and all others who participated in the raffle.

Thank you all in advance for your support of **Toys for Tots**!

If you want more information on the **Toys for Tots** program, please feel free to contact me at jsm@grummanbutkus.com and I will be happy to help out. Happy Holidays and Merry Christmas!

Jason McDonald, CPD, Newsletter Editor
jsm@grummanbutkus.com; 847 328.3555 x204

MEMBERSHIP UPDATES

Remember that if you change companies, email addresses, personal information and the like, PLEASE contact your VP Membership Rick Butler ASAP (rick@luczak.com or 847 781.5100). This will ensure that you keep getting your ASPE mailings and that your directory information will be accurate. Thanks!



NOVEMBER 2008 MEETING ATTENDANCE

The following list of individuals attended the November 2008 meeting of the ASPE Chicago Chapter. In accordance with ASPE Society policy, these individuals are entitled to 0.75 RU's towards the required 24 RU's needed every two years to maintain CPD registration. Meeting attendance is also recognized by the Illinois Department of Professional Regulation to count as 1 PDH towards the required 30 PDH's needed every two years to renew Professional Engineering licenses.

Dave Anderson	Joe Ficek	Larry Luczak	Chris Rohan
Tom Babcock	Paul Gangloff	Mark Luczak	Jason Romano
Julius Ballanco	Albert Gehrke	Mark Mannarelli	Tim Sack
Brendan Bates	Griff Gehrke	Nevo Martelli	Dick Simms
Bill Bauer	Gabriel Gomez	Shawn McAuliffe	George Sobyra
Rick Butler	Mike Imaoka	Tracy McAuliff	Jeff St. Onge
Dan Courtney	Bob Jackson	Jason McDonald	Jeff Steck
Mike Cusack	Don Johnson	Paul McLafferty	Brandon Taylor
Ken Cutler	Mark Kaulas	Jack Miller	John Triphahn
Mike Cwanek	E.J. Kedzie	Tony Navarro	Mike Vandenberg
Andy Daley	Patrick Kennedy	John Nieman	Harold Weil
Natalia Dankanich	Steve Krock	John Obermaier	Bruce Weiss
Ralph Dantino	Phil Kroll	George Pagach	Chris Wisinski
Dave DeBord	Terry LeBeau	Mario Petroyeu	Mel Withrow
Jill Dirksen	David Lehman	Mike Ponx	Peter Wu
Tony DiVito	Ed Lichner	Kerbie Reader	Mike Wijuda
Mike Dore	Mark Loth	Dennis Richards	
Jim Feeney	Dave Luczak	Victor Rilling	

This printing constitutes our record of who was in attendance. We apologize for any misspelling of names and ask that for future sign-ins, please print legibly. Thank You!

OCTOBER ATTENDANCE CORRECTION

The October attendance list incorrectly showed someone called Ken Carlton. In reality, and if we were all masters at reading handwriting, we would have seen (maybe) that it was actually Ken Cutler. We ask that when you sign in for a meeting, or have someone else sign you in, that you PLEASE write clearly. When in doubt, print! Thank you.

Jason McDonald, CPD; Newsletter Editor



ANOTHER GRAND EVENT

The ASPE 2008 biennial Convention and Engineered Plumbing Exposition in Long Beach, Convention No. 21, went very well. Each Convention is bigger and better. The displays of the 600-plus exhibitors were impressive. The traffic was good and it took all of the 10½ hours of show time to walk through and see it all.

The 49 Technical Seminar sessions were well attended. Our Chapter President Dave DeBord gave a session on LEED Points and Strategies. CEU's were issued for Exposition and Technical Seminar attendance.

The business sessions were attended by 288 of 349 eligible delegates representing 7,015 Society members. Discussion and voting on bylaws amendments was long. Voting of Society Officers included our Julius Ballanco being reelected Society President and our Tim Smith being reelected Region 5 Director. Our Chapter received a Chapter award of Merit and Jason McDonald and Joe Ficek each received Special Awards of Achievement.

The Saturday Delegate and Welcome Reception, Sunday Delegate and Welcome event and Tuesday closing Banquet were enjoyable.

Thank you to the Manufacturers who donated the gift bags, Hospitality Suite gifts and drawing prizes. Stanley Wolfson and the Society staff did an excellent job handling all the details of a successful EPE.

Thank you for allowing me to serve as one of our Chapter delegates.

Don Johnson, Chapter Historian



2008 CONVENTION REPORT

Since the "Great Convention of 1984" in the State of Chicago, I have attended each one except Phoenix in 1996. Almost all have exceeded the previous one in hospitality, activities, technical content, etc. This one was no exception.

The organizers did an excellent job. The facilities were without question the best I have seen. The proximity of the Convention Hotel to the Convention Center could not be beat. The Hospitality Room was constantly supplied with refreshments and helpful people. This is always a big part of enjoying and exploring a new city. The "help desk" located in the Convention Hotel lobby was a great help, too.

The Technical Sessions were excellent. I continue to learn something new at these Sessions even though my 35++ years of experience have put a lot of "snow on my roof." There are always topics offered that teach something new or offer a review of something we think we know. One constructive criticism for the Technical Sessions--why not have some additional Technical Sessions (or repeats of Sessions) available on the afternoon of the last day (Wednesday) or during some of the mornings when there is free time?

The Expo was great - well laid out and easy to get around; but, the locations where the lunches were provided were difficult to locate. Am I the only person that had trouble hearing and/or understanding the names announced for the prizes? (*Editor's Note: No, Bob, you were not. It was like listening to the old CTA announcers on the El!*) One constructive criticism for the Expo—consider providing chairs for the lunches. As in years past, people were leaning against the wall or sitting on the floor in the back corner of the hall while eating—this does not project the professional image we are trying to improve. Why not add some chairs and a few tables to allow people to eat without having to sit on the floor? I realize the exhibitors want people in their booths, but the chairs would be a welcome addition that should not affect booth attendance. As a matter of fact, locating the chairs at the far end of the room would mean that the people would still have to walk down the aisles to exit the Expo.

Bob Dahlmann, PE, CPD



ANOTHER CONVENTION REPORT



My thanks to all of those who selected me to represent the Chicago Chapter at the 2008 Convention and EPE. I found the opportunity interesting, informative and professionally helpful. Long Beach was my second Convention, but my first as a Chicago Chapter delegate. First, as I sat there listening to views and counter views with our fellow ASPE members, I thought there were a lot of people who like to hear themselves talk. The more time I gave to digest it, I really think MOST of the speakers are simply passionate and really want to improve and grow the Society as a whole.

Attending the business meetings showed me the numbers of concerned and active members across the country. Our Chapter has its own ideas as to how the national level should act and do business. Some of these ideas are shared by other Chapters and some that are not. All large groups are bound to have differences of opinion as to the direction they should go. The democratic process that the Society has in place allows for all thoughts and opinions to be heard by the delegate members. I heard concerns that smaller chapters have that we in Chicago do not. Even though, politically I would consider myself conservative, I can understand that there is a genuine need and benefit to ASPE to help those Chapters who need it. As a professional organization we can all benefit from the combined knowledge of its thousands of members. Whether they be new technologies, pitfalls to avoid or education of new engineers and designers the vast experience that ASPE members share with one another is terrific. Examples of this are the data books that are rewritten and revised for the most part by ordinary members who want to contribute their talents to the Society.

I feel a personal obligation to all those who have taught me the skills that I use to provide for myself and my family. I feel at times, that I cannot compare experience and expertise to those who have taught me, but I still wish to give back what I can in whatever way that may be useful. It's something personal that I would not project or demand from others but I am confident that it is the way I should feel and that someone would be grateful for the help.

Sean Allard

2008-2009 ASPE Chicago Chapter Meeting Schedule

DATE	PRIMER	TECHNICAL PRESENTATION	LOCATION
September 18	Zero Power Fixtures; Repco Associates	Plumbing Fixtures and LEED; Kohler Company	<i>LaVilla 3638 N Pulaski Chicago</i>
October 16	Water Heater Controls; Luczak Sales	High Efficiency Water Heaters - When is the Proper Application?	<i>The Parthenon 314 S Halsted Chicago</i>
November 20	Medical Gas Inlets/Outlets; Ohio Medical	Booster Pumps - Variable Speed Drives and their Implications on Booster Pumps; Advanced Mechanical Technologies	<i>Rosewood Restaurant 9421 Higgins Rosemont, IL</i>
December 18	Booster Night; <i>Special Entertainment</i>		<i>LaVilla 3638 N Pulaski Chicago</i>
January 15	Acid Waste and High Purity Piping; Zurn Acid Waste Piping	Alternative Venting Methods; Joint Meeting	<i>Rosewood Restaurant 9421 Higgins Rosemont, IL</i>
February 19	CPVC Sprinkler Piping	Clean Agent Fire Systems and Proper Room Design; Reliable Fire Equipment	<i>The Parthenon 314 S Halsted Chicago</i>
March 19	Point-of-use Water Heaters; Chronometer & Deery-Pardue	Solar Water Heating; Bornquist	<i>LaVilla 3638 N Pulaski Chicago</i>
April 16	Technical Seminars	38th Annual ASPE Chicago Product Show	<i>White Eagle 6839 Milwaukee Ave Niles</i>
May 21	Elections	Vacuum Plumbing Systems; Deery-Pardue	<i>The Parthenon 314 S Halsted Chicago</i>
June 19	Annual ASPE Chicago Golf Outing		<i>Hilldale Golf Club 1625 Ardwick Drive Hoffman Estates</i>
July 18 (tentative)		ASPE Ride to the Rock	 <i>Chicagoland to Starved Rock</i>